



## MK5011 Master Keyed 5 Lever Horizontal Mortice Lock



<b>Description</b>	Master keyed 5 Lever horizontal mortice lock for use on external wooden hinged doors providing a high level of security. CE Marked door lock Fire rated to BS EN 1634-1:2000 & Performance rated to BS EN 12209. Latchbolt operated by knob from either side Deadbolt operated by key from either side. Supplied with 2 keys, striker plate and fixing screws. Finishes stainless steel (SS) or satin brass (SB). Other finishes available. Available master and sub and grand master keyed.
<b>Operation</b>	Latchbolt operated by knob from either side Deadbolt operated by key from either side
<b>Case</b>	Pierced to accept 38mm centre horizontally opposed bolt through fixing furniture
<b>Striker Plate</b>	Type B with dust box DB1
<b>Latchbolt</b>	Brass, reversible. Projection 12mm
<b>Deadbolt</b>	Brass, with two hardened steel rollers. Throw 16mm

**Follower** Brass, to suit 8mm square spindle Two-way action

**Differs** Available master and sub and grand master keyed

**Rebate Units To Suit** G3057-13mm G3058-19mm G3059-25mm

**A Lock Case** 127mm

**B Backset** 45mm

**C Centres** 57mm

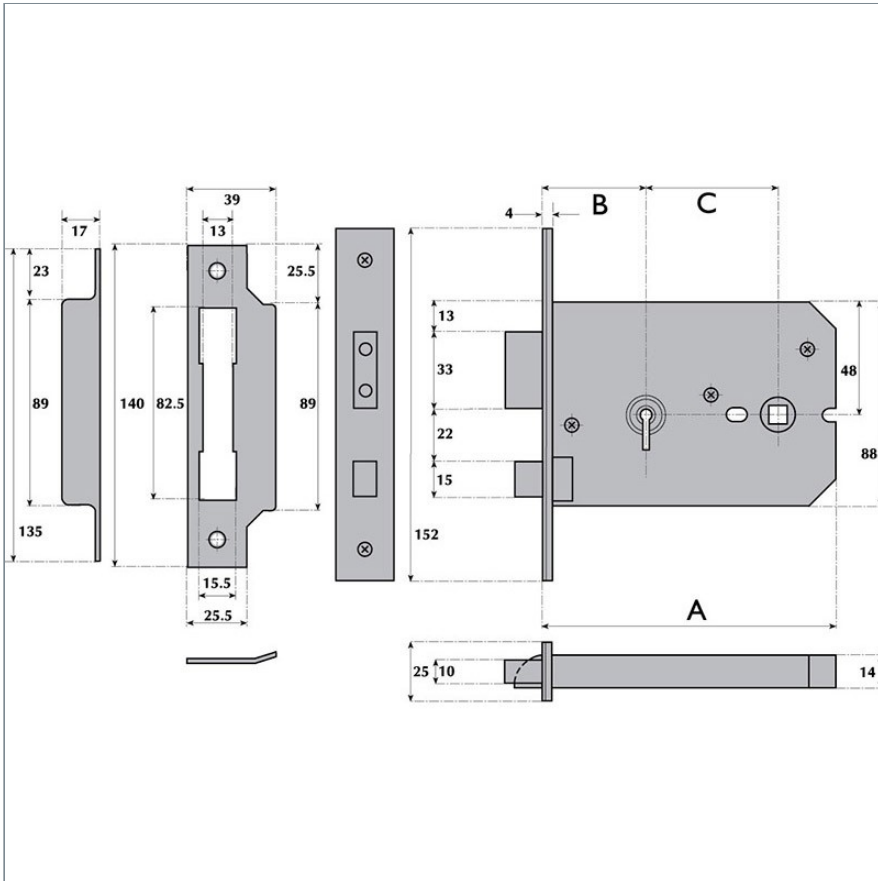

Guardian Lock & Engineering Co Ltd. Imperial Works, Wednesfield Road, Willenhall, West Midlands, WV13 1AL, United Kingdom.

+44(0)1902 635 964 | sales@imperiallocks.co.uk